



10710 Sanden Drive, Dallas, TX 75238

TECHNICAL SERVICES ADVISORY MEMO

TO: Distribution
FROM: Technical Services
DATE: March 15, 2018
SUBJECT: NIC Panel Screw Attachment

Lower NIC183S01 panel magnets may not hold the panel in place. To remedy:

Step 1: Obtain two #8 sheetmetal screws at least ¼ inch long, with pointed tips. Stainless steel, Phillips truss or pan head would have better appearance, but not required.

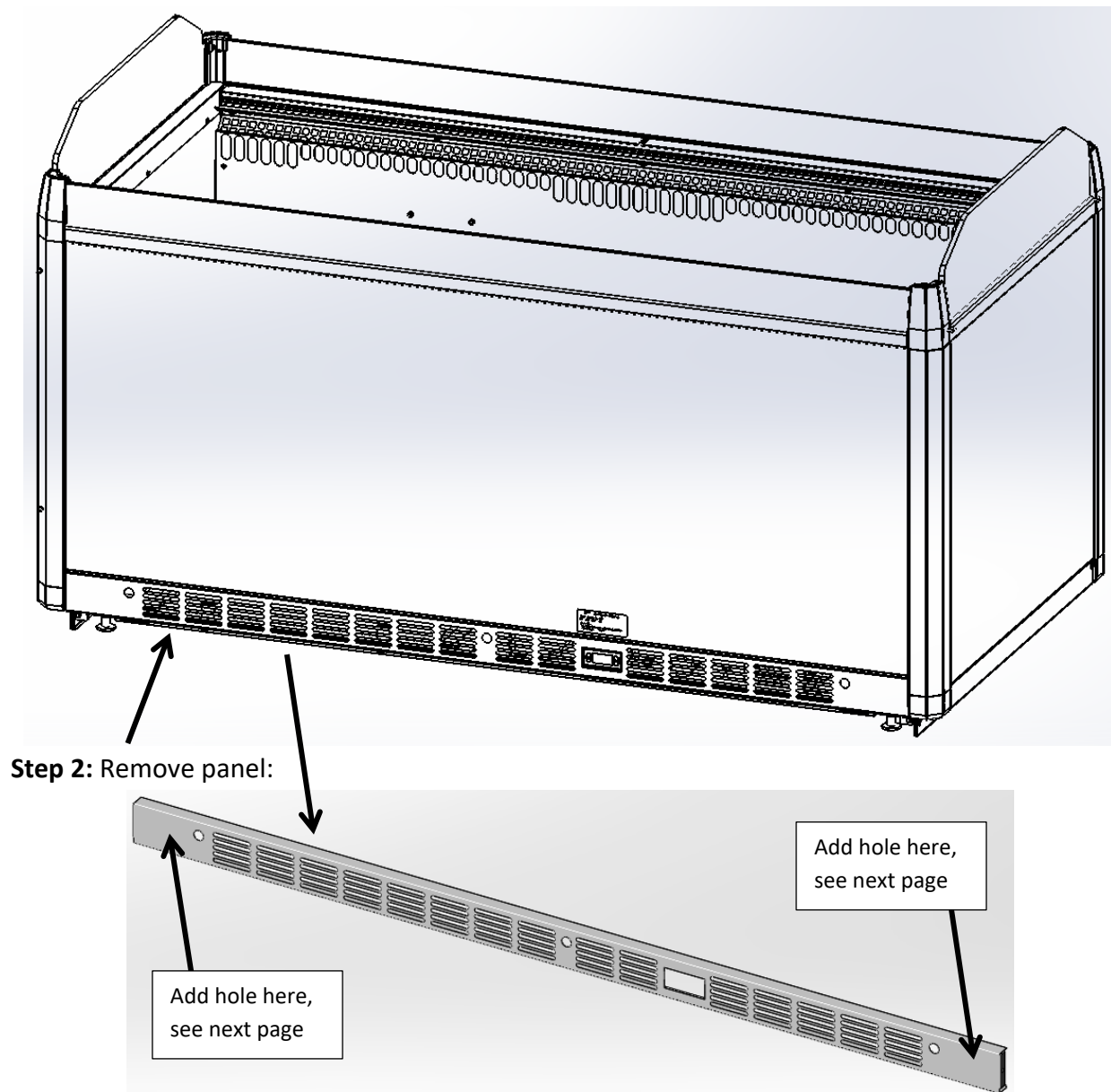

Step 3: Drill two ¼ inch diameter holes in locations shown. The images below are full size when printed, so the location can be marked using this page.

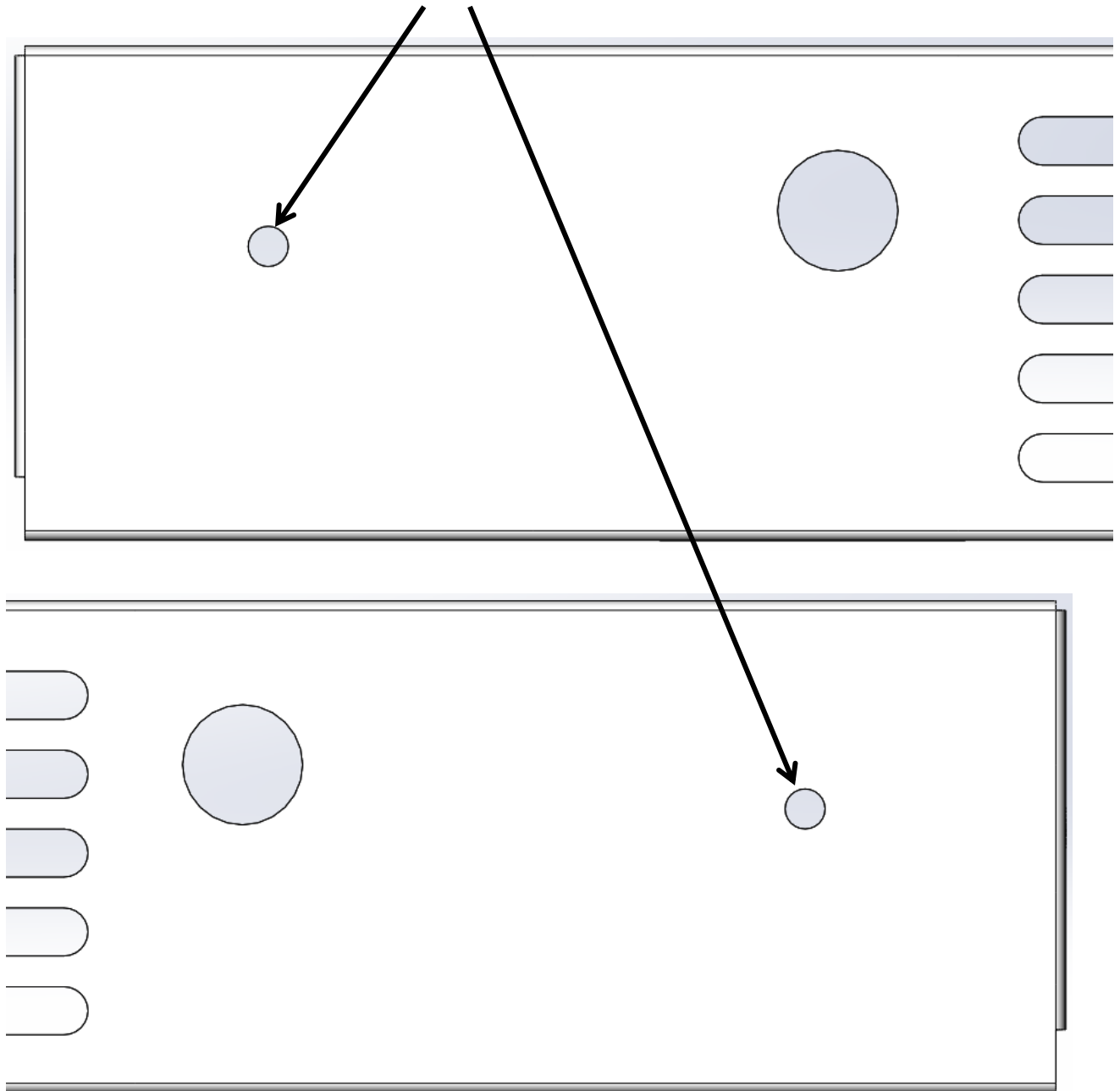

Step 4: Reinstall panel and install screws in holes that were added to panel.

If you need further information or assistance, please contact Sandenvendo Technical Services at **800-344-7216, Ext. 9935.**