



# Installation Instructions

*The Next Dimension in Technical Service Information*

**Kit Number:** See Chart  
**Installation Instructions:** HFOD Food Shield Installation  
**Product:** HFOD  
**Subject:** Food Shield Installation  
**Purpose:** Installation of Food Shields for all HFOD models

**Date:** 07-01-2019  
**Rev.:** A  
**ECN:** 57596  
**Rev. Date:** 07-01-2019

Parts List														
HFOD 24 Kit 1269844		HFOD 30 Kit 1269852		HFOD 36 Kit 1269879		HFOD 42 Kit 1269887		HFOD 48 Kit 1269895		HFOD 54 Kit 1269909		HFOD 60 Kit 1266586		Description
Quantity	Part Number	Quantity	Part Number	Quantity	Part Number	Quantity	Part Number	Quantity	Part Number	Quantity	Part Number	Quantity	Part Number	
1	1266917	1	1266917	1	1266917	1	1266917	1	1266917	1	1266917	1	1266917	Instl, Inst, HFOD Food Shield
1	1266438	1	1266438-1	1	1266438-2	1	1266438-3	1	1266438-4	1	1266438-5	1	1266438-6	Asy,Food Shield,Top Shelf
1	1266462	1	1266462-1	1	1266462-2	1	1266462-3	1	1266462-4	1	1266462-5	1	1266462-6	Asy,Food Shield,Btm Shelf
1	1266454	1	1266454-1	1	1266454-2	1	1266454	1	1266454	1	1266454	1	1266454	Brkt,Fd Shld,Top- Right,HFOD
1	1266454-1	1	1266454-1	1	1266454-1	1	1266454-1	1	1266454-1	1	1266454-1	1	1266454-1	Brkt,Fd Shld,Top- Left,HFOD
1	1266454-2	1	1266454-2	1	1266454-2	1	1266454-2	1	1266454-2	1	1266454-2	1	1266454-2	Brkt,Fd Shld,Btm- Left,HFOD
1	1266454-3	1	1266454-3	1	1266454-3	1	1266454-3	1	1266454-3	1	1266454-3	1	1266454-3	Brkt,Fd Shld,Btm- Right,HFOD

**Special Note:** Food Shields are designed for installation of the unit shelves in a tilted configuration.

## Procedure

**Step #1** Turn-off and disconnect the Case from the power source.

**Step #2** Identify Components

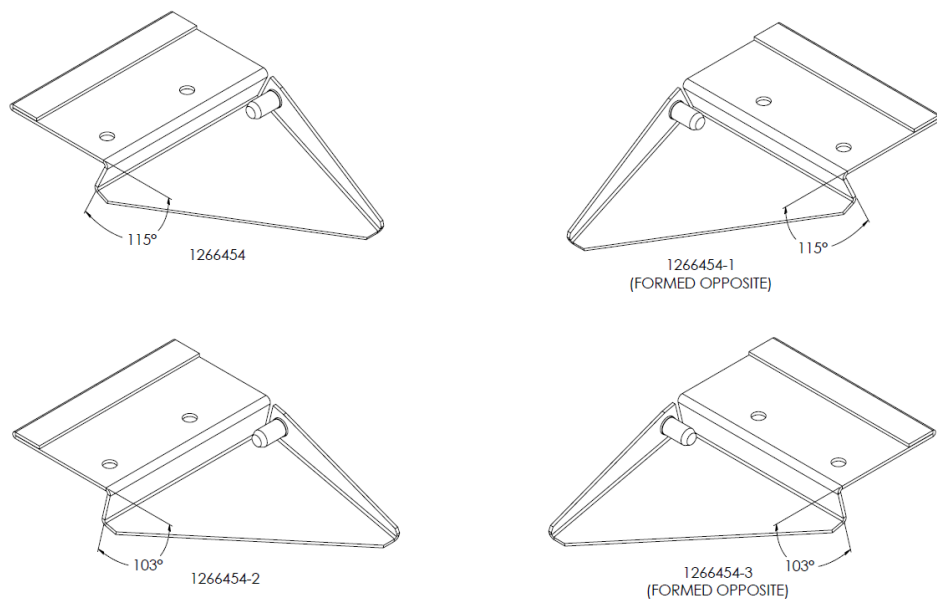

**Food Shield Brackets (These vary based on the bend angle, and the direction they are formed)**

**FIGURE 1**

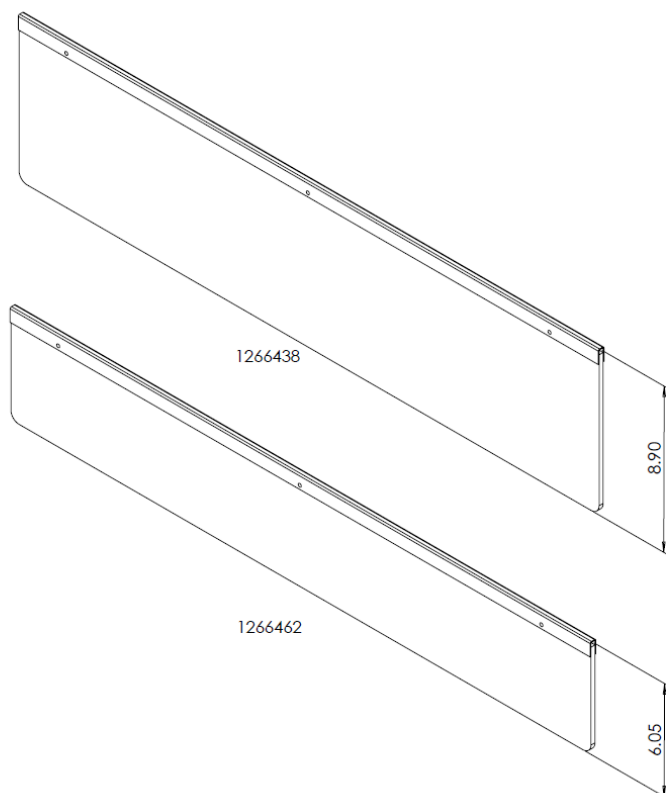

**Food Shields (These vary based on the overall height)**

**FIGURE 2**

**Step #3 Identify Component locations**

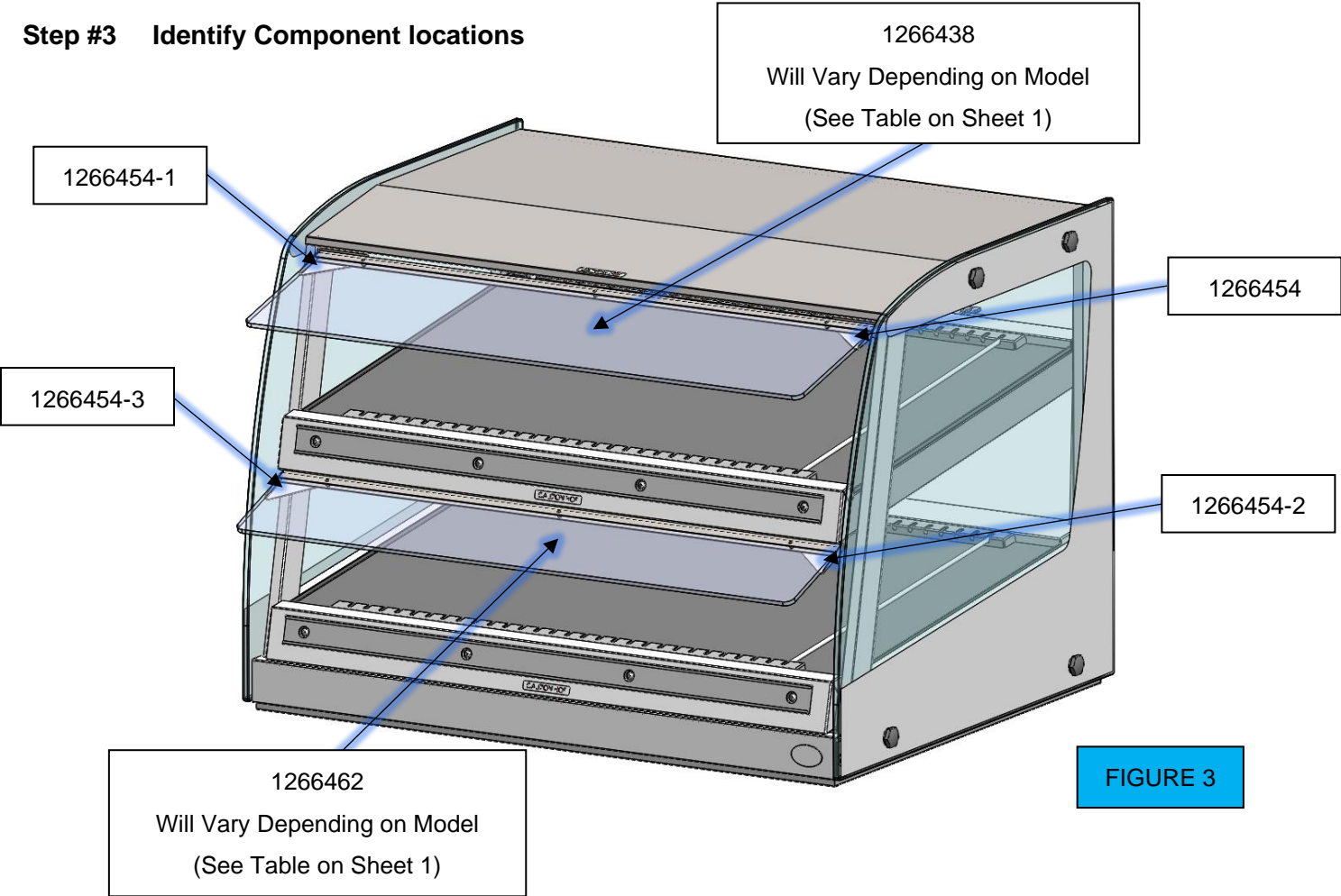

**Step #4 Remove 4x sets of 2 screws from the locations show in (Figure 4)**

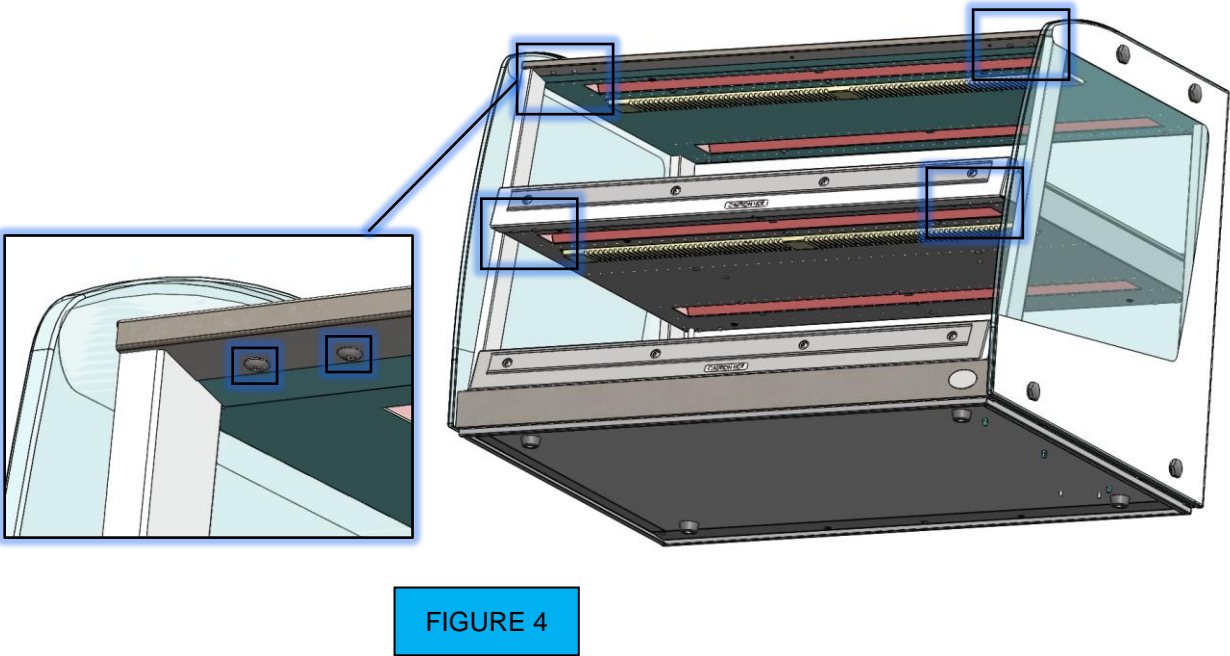

**Step #5** Install Food Shield brackets as shown onto the front of the unit in Figure 5 (Use hole locations / screws removed from step 4)

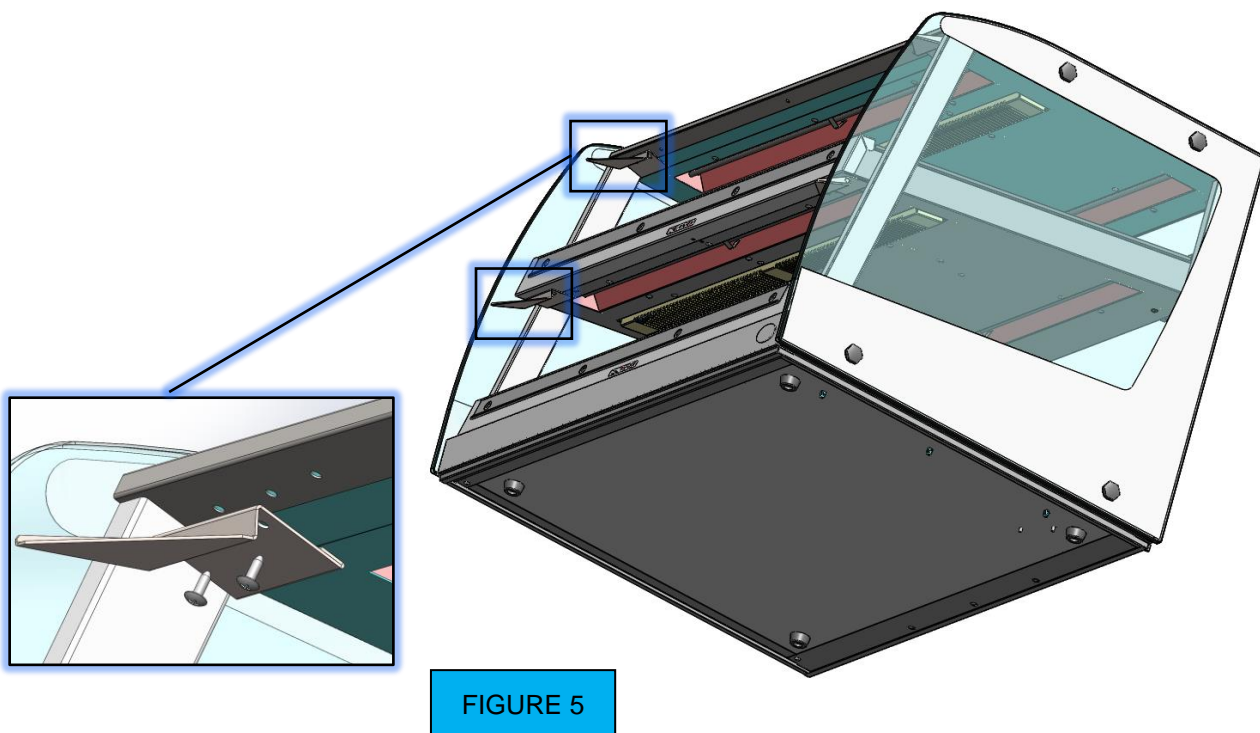

**Step #6** Install the Top Food Shield onto the Food Shield brackets from step 5 as shown in Figure 6. (Must hold in this position during the next step).

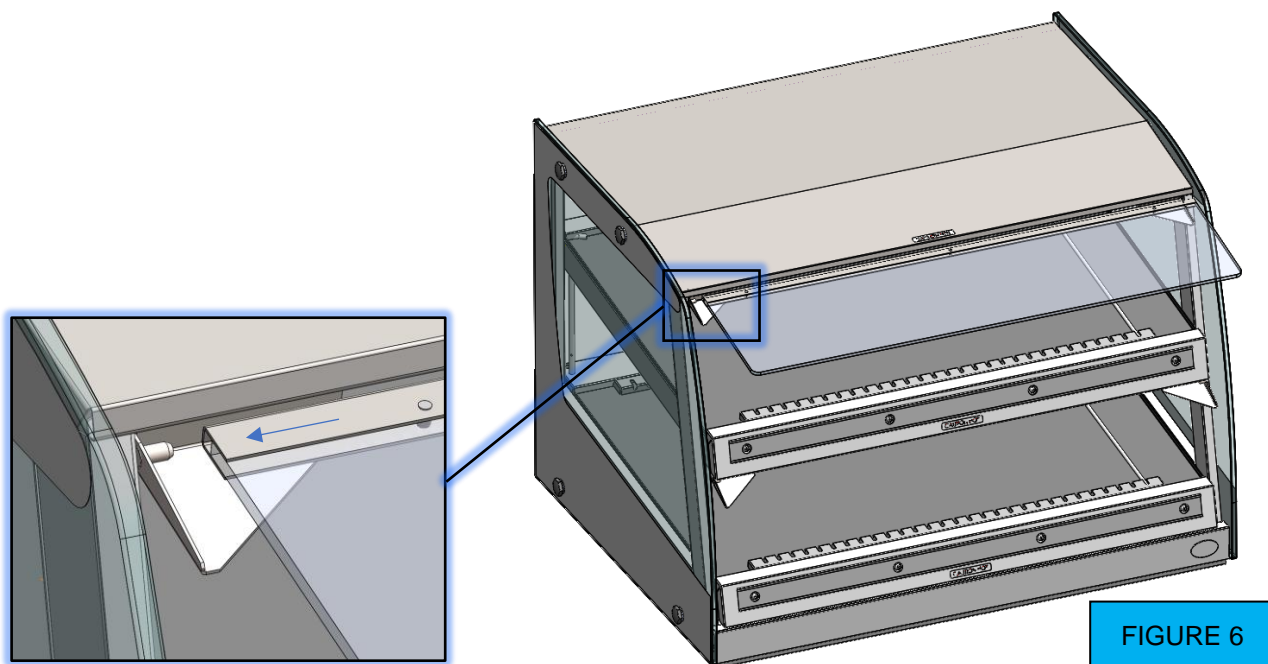

**Step #7** While holding the door from the previous step install the opposite hand Food Shield bracket into the door (Figure 7). Then secure the bracket, and door to the hot food unit using the hole locations / screws removed from step 4 (Figure 8). Note: The door will need to be held in the upward direction to access the screws.

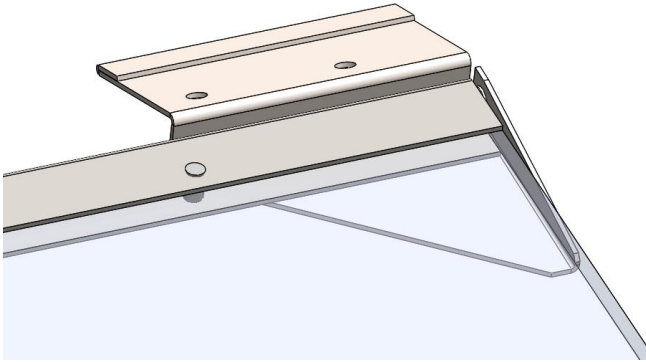

FIGURE 7

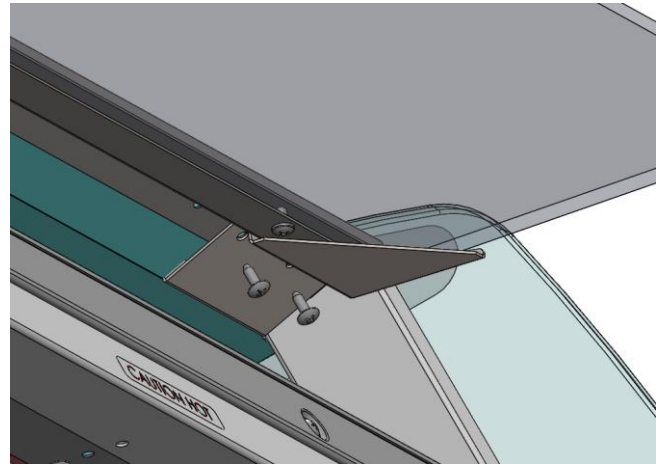

FIGURE 8

**Step #8** Repeat steps 6 & 7 for lower shelf Food Shield